

General Duty Series 100-500 - Faultless

Ideal for: General applications in warehouses and factories; a good combination of strength, durability and economy.
Available Wheel Material:

Ruborex

Composition rubber wheel combines a soft rubber tread with a hard rubber core for quiet movement, a cushioned ride and maximum floor protection.

Rocktite

Hard-rubber molded composition throughout, this wheel is impervious to oils and greases. High load rating, good mobility.

Sintered Iron

Powdered iron, compacted and sintered to cast-iron strength, makes a concentric and smooth tread that runs quietly and protects floors.

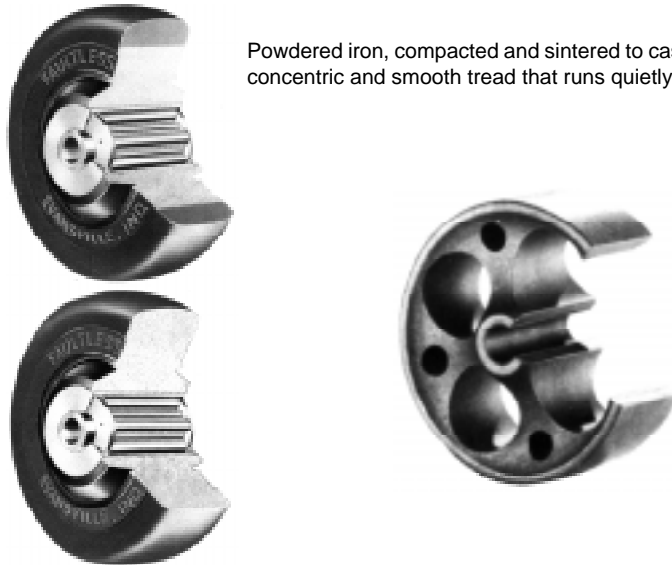

Caster No		Wheels					Specification	
Swivel Caster No.	Rigid Caster No.	Dia. "A" (in.)	Tread Width (in.)	Type	Bearing	Load Cap. (lbs.)	Overall Hgt. (in.)	Swivel Radius (in.)
25028	108-2	2	1	SI	Plain	150	2-1/2	1-3/4
25082	121-2	2	1	Rub.	Self Lub.	90	2-1/2	1-3/4
25124	127-2	2	1	RC	Self Lub.	150	2-1/2	1-3/4
25091	121-3	3	1-1/4	Rub.	Self Lub.	175	3-13/16	2-7/16
25136	127-3	3	1-1/4	RC	Self Lub.	270	3-13/16	2-7/16
25149	127-4	4	1-5/16	RC	Self Lub.	350	5	3-3/16
	24506 521-3							
	25790 527-4							

Rub. - Ruborex
RC - Rocktite

SI - Sintered Iron

Series 100 Swivel



Series 500 Rigid



Top Mounting Dimensions and Mounting Hole Spacing

Wheel Size(in.)	Size of Top Plate D x E	Mounting Hole Spacing F x G
2	100 Series Wheel 1-7/8 x 2-9/16	15/16 x 2-1/8
3	3-1/8 x 4-1/8	2-3/8 x 3-3/8 x 3-7/16
4	4 x 5-1/8	3 x 4
3	500 Series Rigid 2-1/2 x 4-15/16	1-3/16 x 4
4	3-1/8 x 6-1/4	1-3/4 x 5

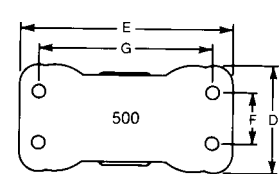
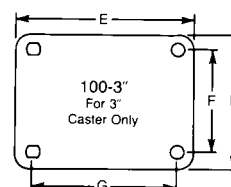
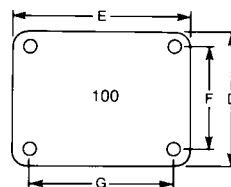

Light Duty Series EP - Faultless

Ideal for: Light assembly dollies and trucks, bakery racks, portable files, tool boxes, display racks and many other uses.

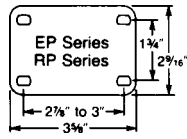
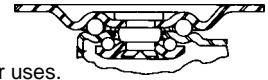

Caster No	Wheels					Specification	
Swivel Caster No.	Dia. "A" (in.)	Tread Width (in.)	Type	Bearing	Load Cap. (lbs.)	Overall Hgt. (in.)	Swivel Radius (in.)
29906 EP4520	3	13/16	Rub.	Self Lub.	90	3-3/4	2-3/4
29909 EP4520 RB	3	13/16	Rub.	Self Lub.	90	3-3/4	2-3/4
29918 EP4521	4	15/16	Rub.	Self Lub.	115	4-1/316	3-5/16
29933 EP4522	5	15/16	Rub.	Self Lub.	125	5-13/16	3-15/16

Rub. - Ruberex
RB - Rollock Brake

Light - Medium Duty Series 400 - 7700

Ideal for: Laundry trucks, milk-case dollies, stock trucks, hotel trucks and many other light-medium duty applications.

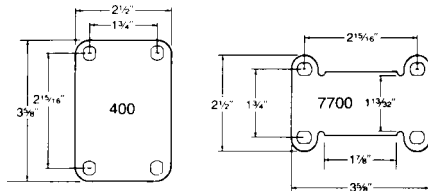
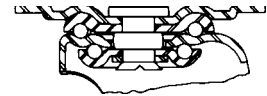

Caster No		Wheels				Specification		
Swivel Caster No.	Rigid Caster No.	Dia. "A" (in.)	Tread Width (in.)	Type	Bearing	Load Cap. (lbs.)	Overall Hgt. (in.)	Swivel Radius (in.)
25499 421-2-1/2	25110 7721-2-1/2	2-1/2	1-1/8	Rub.	Self Lub.	100	3-5/16	2-3/8
25447 427-2-1/2	25111 7727-2-1/2	2-1/2	1-1/8	RC	Self Lub.	200	3-5/16	2-3/8
24578 421-3	25113 7721-3	3	1-1/4	Rub.	Self Lub.	175	3-3/16	2-3/4
25451 427-3	25114 7727-3	3	1-1/4	RC	Self Lub.	270	3-3/16	2-3/4
25460 427-4	25099 7727-4	4	1-1/4	RC	Self Lub.	275	5	3-7/16

Rub. - Ruberex RC - Rockite

Institutional Casters Threaded Stem Casters - Faultless

Double-ball bearing design makes the easy-swivel Series EY ideal for metal furniture, carts, racks, appliances and more.



Caster No	Wheels					Specification	
	Dia. "A" (in.)	Tread Width (in.)	Type	Bearing	Load Cap. (lbs.)	Overall Hgt. (in.)	Swivel Radius (in.)
24522 EY459R w/ Stem 507-69	2	7/8	Rub.	80	2-17/32	3/8-16 x 1-1/2	

Rub. - Ruberex

Furniture Casters Standard

Ideal for: Office chairs, library carts, miscellaneous institutional and office equipment.

Standard Features: Faultless Double Ball Bearing Construction uses two full rows of hardened ball bearings rolling around two separate, hardened, lubricated raceways. The Faultless design uses more ball bearings than ordinary split-level construction, offering superior swivelingaster's load is more evenly divided. The swivel assembly is precision-formed and securely shanked to prevent stem wobble.

- Upper ball race - large-diameter precision-formed, hardened, lubricated.
- Center member - one-piece hardened horn between two full rows of bearings.
- Lower ball race - precision-formed, hardened and lubricated.



6

Caster No.	Dia. (in.)	Type (lbs.)	Load Cap. (in.)	Overall Hgt.	Finish
24413 PB8478	1-5/8	Rub.	70	2-1/4	Copper Ox.
24415 PB8479	2	Rub.	80	2-5/8	Copper Ox.

Rub. - Ruberex

8000 Wood Furniture Stem

Bore dimensions:
3/8" dia., 1-5/8" depth
Grip neck sockets.

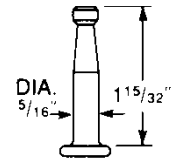

Caster No.	Dia. (in.)	Type (lbs.)	Load Cap. (in.)	Overall Hgt.	Finish
30247 EW439R	2	Rub.	80	2-17/32	Bright Nickel
30191 EW4311R	2-1/2	Rub.	80	3-1/32	Bright Nickel

Rub. - Ruberex
R - Rivet Axle

EW Friction Grip Stem

Bore Dimensions:
.453" - .461" dia., 1-9/16" depth.
Stem can be used with EW tube sockets or brackets.

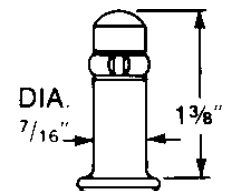

Caster Inserts

Caster Insert No.	Description	Pieces per Card
31936	5/8" Insert	4
31937	3/4" Insert	4
31939	1" Insert	4

Caster Insert

- 31936** 5/8"
- 31937** 1"



Twin-Wheel - Faultless

Standard Features: Nylon hooded caster offers designer styling combined with economy. Independent wheel rotation adds to its already high, controlled mobility - from deep pile carpeting to slick tile. Meets or exceeds BIFMA and ANSI durability standards for hard-tread casters.

Caster No.	Dia. (mm)	Type	Load Cap. (lbs.)	Overall Hgt. (in.)	Finish
24432 IT332-50BLK	50	Nylon	90	2	Black
24434 IT334-50BRA	50	Nylon	90	2	Bright Brass

Wood Furniture Stem

Bore dimensions:
3/8" dia., 1-5/8" depth.
Grip neck sockets.

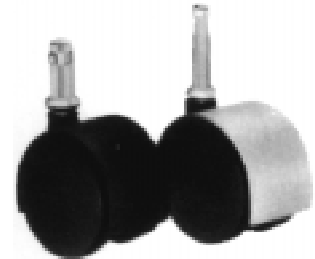
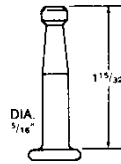

Flat Top Plate

Caster No.	Dia. (in.)	Type	Load Cap. (lbs.)	Overall Hgt. (in.)	Finish
24437 IT932-50BLK	50	Nylon	90	2	Black
24439 IT934-50BRA	50	Nylon	90	2	Bright Brass

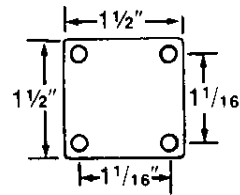

Royal Roll

Standard Features: Faultless Royal Roll® Casters combine a strikingly elegant spherical look with smooth swiveling, double-ball bearing construction. The wheel is a Ruberex® rubber ball: easy-rolling on carpeted floors, quiet and non-marking on tiled surfaces.

Caster No.	Dia. (in.)	Type	Load Cap. (lbs.)	Overall Hgt. (in.)	Finish
24411 PB86B48	1-5/8	Rub.	70	2-1/4	Bright Brass
28818 PB86B49	2	Rub.	80	2-21/32	Bright Brass

Wood Furniture Stem

Bore dimensions:
3/8" dia., 1 5/8" depth.
Grip neck sockets.

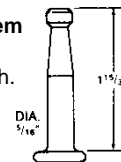

Flat Top Plate

Caster No.	Dia. (in.)	Type	Load Cap. (lbs.)	Overall Hgt. (in.)	Finish
24412 PB96B48	1-5/8	Rub.	70	2-1/4	Bright Brass
28821 PB96B49	2	Rub.	80	2-21/32	Bright Brass

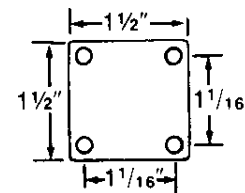

Rub. - Ruberex

Coronet Decorative Metal Ball Caster - Stem

Caster No.	Description	Finish	Pcs. per Box
24452 PBC391-200	2" Ball	Antique	2
24461 PBC394-200	2" Ball	Bright Brass	2
28825 PBC391-212	2-1/2" Ball	Antique	2
28826 PBC394-212	2-1/2" Ball	Bright Brass	2

Supplied with socket



Coronet Decorative Metal Ball Caster - Plate

Caster No.	Description	Finish	Pcs. per Box
24453 PBC991-200	2" Ball	Antique	2
24462 PBC994-200	2" Ball	Bright Brass	2
28823 PBC991-212	2-1/2" Ball	Antique	2
28824 PBC994-212	2-1/2" Ball	Bright Brass	2

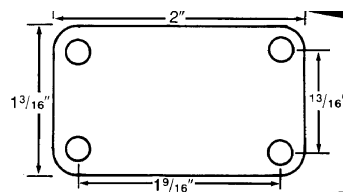

General Furniture Casters Series 4000 Stem Casters - Faultless

Economical, ball-bearing stem caster offers choice of grip neck sockets for light wood or metal furniture. Stem holds securely in metal or plastic sockets. Bright brass finish.

Caster No.	Wheel dia. x Face	Type	Load Cap. (lbs.)	Overall Hgt. (in.)
32252 PB4345M	1-1/4 x 9/16	White Plastic	30	1-21/32
24402 PB4348M	1-5/8 x 11/16	White Plastic	60	2
32254 PB4340M	2 x 17/32	White Plastic	40	2-1/2
24403 PB4345W	1-1/4 x 9/16	Black Plastic	30	1-21/32
24401 PB4348W	1-5/8 x 11/16	Black Plastic	60	2

Wood Furniture Stem
Bore dimensions:
3/8" dia., 1-5/8" depth.
Grip neck sockets.

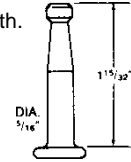

Series 5000 Plate Casters

Deeply corrugated horn and swivel top plate make this an exceptionally strong caster for its size. Recommended for smaller appliances and light furniture with a flat base. Bright brass finish.

Caster No.	Wheel dia. x Face	Type	Load Cap. (lbs.)	Overall Hgt. (in.)
32253 PB5345M	1-1/4 x 9/16	White Plastic	30	1-21/32
24406 PB5348M	1-5/8 x 11/16	White Plastic	60	2-1/16
24407 PB5345W	1-1/4 x 9/16	Black Plastic	30	1-21/32
24405 PB5348W	1-5/8 x 11/16	Black Plastic	60	2-1/16

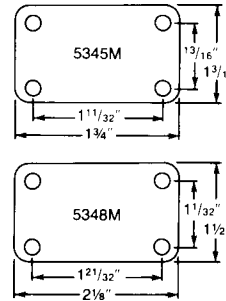

6

Series 9000 Plate Casters

Double-ball-bearing swivel makes this a quality plate caster for flat-base furniture such as chests, cabinets and lighter school and hospital equipment. Top plate bolts or welds to flat bases. Zinc copper oxidized finish.

Caster No.	Wheel dia. x Face	Type	Load Cap. (lbs.)	Overall Hgt. (in.)
28474-9459R	2 x 7/8	Rub.	80	2-5/8
24416 PB9479	2 x 7/8	Rub.	80	2-5/8
28486-94520R	3 x 13/16	Rub.	90	3-19/32



Swivel Top Plate

Wheel Dia.	Top Plate Size	Mounting Hole Spacing
2	2 x 1-3/16	1-9/16 x 13/16
3	2-1/8 x 1-1/8	1-9/16 x 13/16

Bed Frame Caster - Stem

Caster No.	Description	Finish	Pcs. per Box
28811 PBGA34-2	2" Bed Roller	Bright Brass	2



Mapp Caster

Caster No.	Description
SB 9706 RP	2" BACO Swivel Caster with Brake
SB 10706 RP	2-1/2" BACO Swivel Caster with Brake



6