

Schlage "A" Series Locks

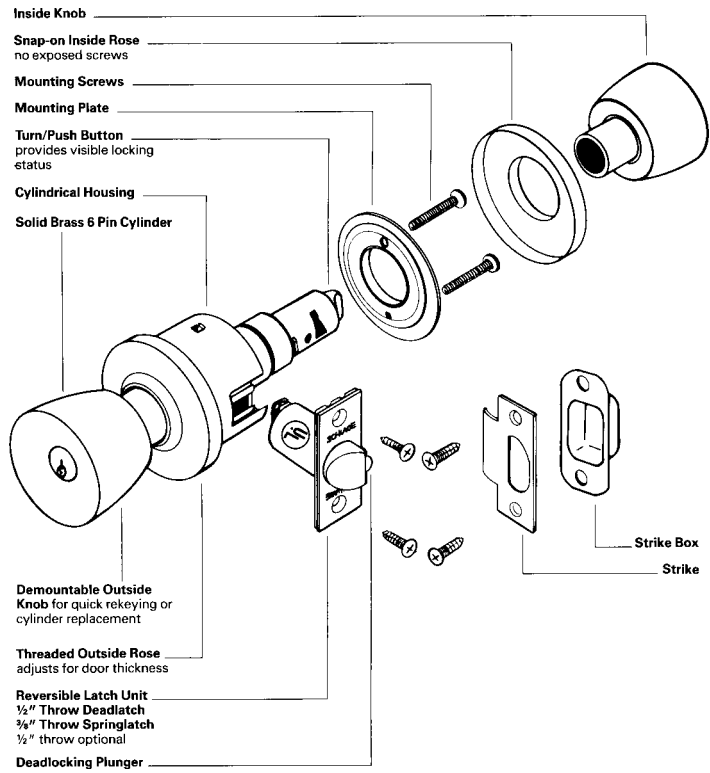
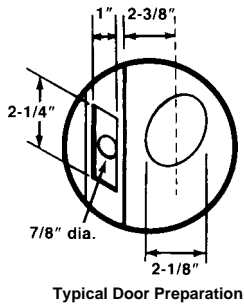

For residential and commercial buildings

Construction...

Mechanism - wrought steel, zinc plated and dichromated with coil compression springs.
 Exposed Trim and parts - wrought brass, bronze, aluminum or stainless steel - knob and rose designs

Keying...

Pin tumbler Cylinders - 5 . pin tumbler extruded brass cylinder plug and housing with nickel silver pins and keys.

Installation...

For hollow metal and wood doors and frames, uniforms, application regardless of function, completely reversible for RH or LH doors, adjustable for doors 1-3/8" to 1-3/4".

Lock Series Selection Guide

Primary consideration for the use of any lock is the frequency of operation expected, the degree of security required, design and quality standards.

"A" locks are recommended for residential and commercial buildings where normal frequency of operation is anticipated, and are consistently used in the following types of installations:

"A" Lock Usage

1. Motels-Hotels
2. Office Bldgs.
3. Commercial Bldgs. - Retail Stores and Warehouses
4. Residential - Sgl. Family
- Multi Family-Low and high rise
5. Medical Clinics and Convalescent Centers, etc.
6. Some Educational Buildings, Church Schools, Kindergarten
7. Churches
8. Condominiums

1/2" throw latches are standard for all pin tumbler locks functions. Listed by Underwriters' Laboratories, Inc. for use on "A" label doors.

Schlage "A" locks meet or exceed in every respect performance requirements for the following.

- (1) Builders Hardware Manufacturers Association (BHMA) Product standards 601, Locks and Locks Trim, Series 4000 for Grade 2.
- (2) Federal Specifications FF-H-106a and FF-H-00106b Series 160 for numerical equivalents.

Schlage Functions

1



A10S Passage Latch:

Both knobs always free.
ANSI - F75-2



A40D Privacy Lock:

Push-button locking. Can be opened from outside by emergency key, screwdriver or similar tool.
ANSI - F76-2



A53PD Entrance Lock:

Turn-button locking-pushing and turning button locks outside knob requiring use of key at all times until button is manually restored to unlock position. Push button locking-pushing button locks outside knob until unlocked with key or inside knob is turned.
ANSI - F81-2



A170 Single Dummy Trim:

Pull only. Mounting plate snap-on rose and knob.

Door Range: 1-3/8" to 1-7/8" standard.

Backset: 2-3/8" standard. 2-3/4" backset available for commercial applications. 2-3/8" and 2-3/4" backset latches available.

Keying: 6 pin tumbler with two nickel silver keys per door.

Stock

Plymouth

Finish 605, 613, 626

Georgian

Finish 605, 609

Orbit

Finish 605, 609, 613, 625, 626

Tulip

Finish 626

Also stocking for commercial application:

Orbit

Finish 613, 626
Backset 2- 3/4"
Strike ANSI 10-025
Springlatch 11-116
Deadlatch 11-096

A10S, A40S, A53PD

AL Series

Door Range: 1-3/8" to 1-7/8" standard.

Backset: 2-3/4" standard. 2-3/8" and 3-3/4" backset latches available.

Keying: 6 pin tumbler with two nickel silver keys per door.

AL53PD Entrance Lock

Turn/push-button locking; pushing and turning button locks outside lever requiring use of key until button is manually unlocked. Push button locks outside lever until unlocked by key or turning inside lever.

Stock

AL10S - Passage Latch

AL40S - Privacy Lock

AL53PD - Entrance Lock

Finishes: 605, 613, 625, 626

Tulip

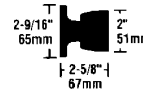
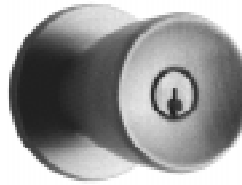

Georgian

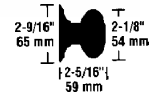

Orbit

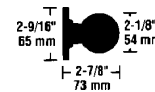

Plymouth

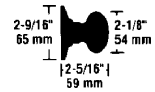

Finishes:

605 (3)

609 (5)

613 (10B)

625 (26)

626 (26D)

Bright Brass, Clear Coated
Satin Brass, Blackened
Stain Relieved, Clear Coated
Oil Rubbed Bronze
Oxidized Satin Bronze
Oil Rubbed, No Coating
Bright Chromium Plated
No Coating
Satin Chromium Plated,
No Coating

SATURN

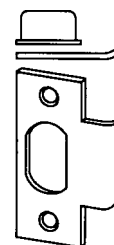
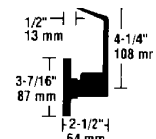
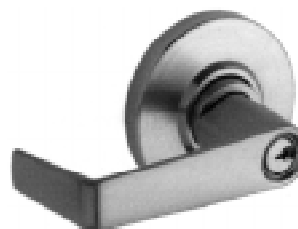

10-001

Standard Strike
Size: 2- 3/4" x 1-1/8" x 3/32"
Lip: 1-1/8" for 1-3/8" and
1-3/4" doors
Finishes: 605,613, 626

Schlage "F" Series Grip Handle Entrance Lock

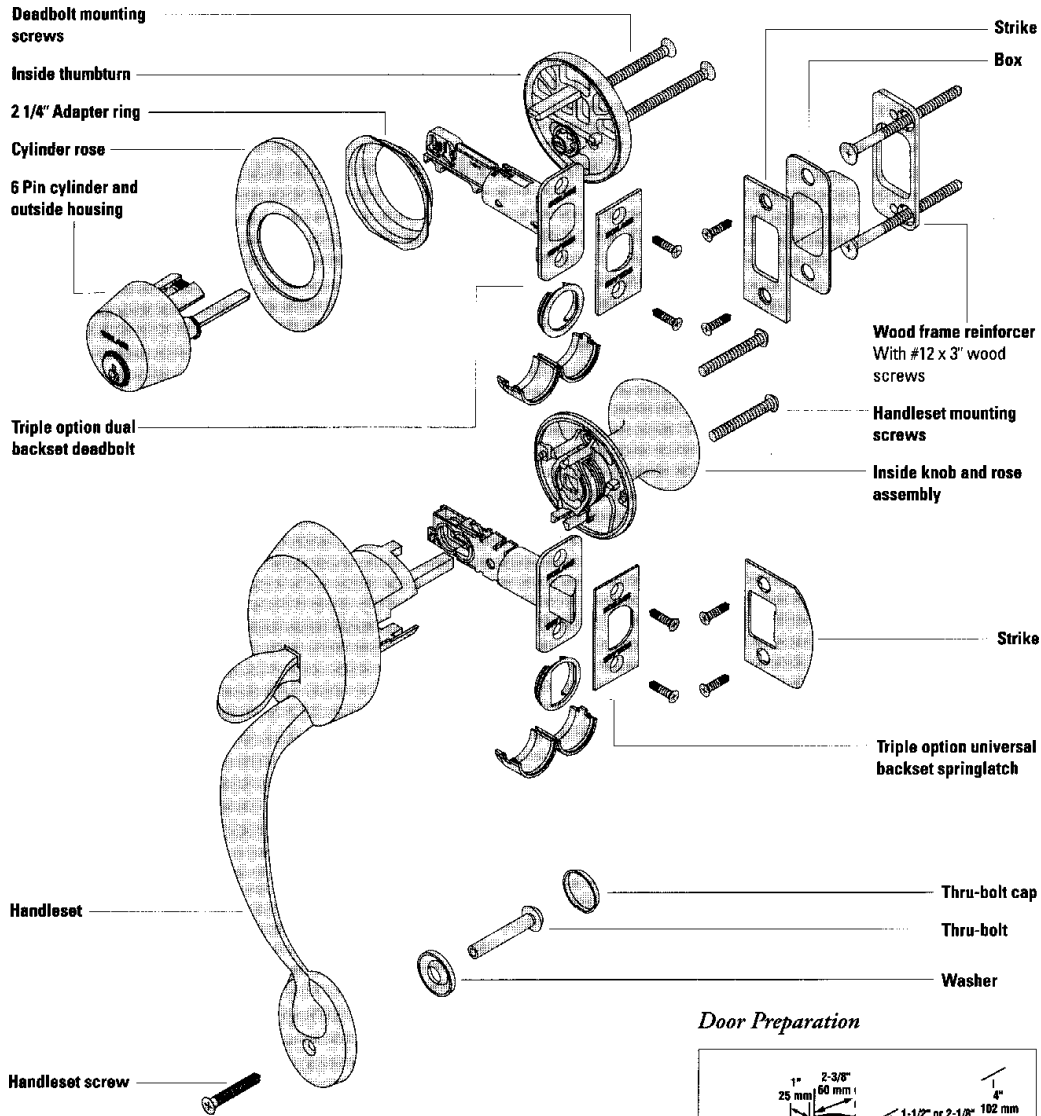

Door Preparation

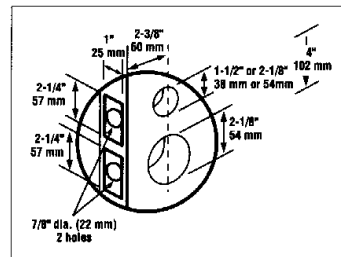

Application: For all Single and Multi-Family Residential Entrance Doors.

Construction: Grip handle and cylinder rose are forged brass or bronze; all other exposed trim is wrought. Grip handle mechanism is adapted to an inside "F" lock chassis with removable knob and rose. All steel parts are zinc plated and dichromated for corrosion resistance. Compression springs are used throughout. Deadbolt has 1" throw with hardened steel roller insert.

Keying: Deadbolt is furnished with a precision built, solid brass five-pin tumbler "C" keyway cylinder with nickel silver pins and two keys each.

Installation: Standard door preparation is the same as other "F" Series, 2-1/8" diameter lock bore, 1-1/2" bore for cylinder. 2-3/8" backset is standard deadbolt and latch faceplate size and bore is identical, 1" x 2-1/4" with 7/8" bore. All locks are completely reversible for RH or LH doors.

Function



Deadbolt thrown or retracted by key from outside or by inside thumb turn. Latch retracted by thumb pieces from outside by inside.

Standard Full Lip Strike
10-026
 1-1/8" lip, 1- 5/8" x 2-1/4"

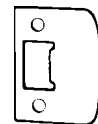

Deadbolt Strike & Box
10-094
 1-1/8" x 2-3/4" x 3/32"



Schlage "F" Series Grip Handle Entrance

1

Bowman (BOW)



Parthenon (PAR)



Plymouth (PLY)



Inside Trim

Georgian (GEO)

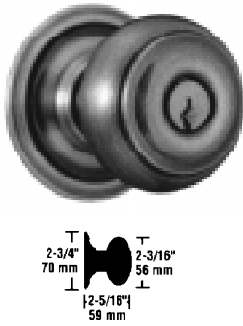

Plymouth (PLY)



Orbit (ORB)

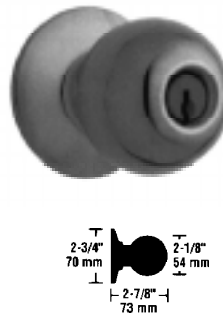

Flair (FLA)



Inside Knob & Rose Combination

Stock

F358 - Outside Trim

F358 Bowman 605
F358 Parthenon 609
F358 Plymouth 605
F358 Plymouth 609

F359 - Inside Trim

F359 Georgian 605
F359 Plymouth 605
F359 Orbit 605
F359 Flair 605
F359 Georgian 609
F359 Orbit 609
F359 Flair 609

Ordering:

Order an F358 and F359 for a complete handleset.
Specify handing on Flair inside trim.

Finishes: 605 - Polished Brass
609 - Antique Brass

Schlage "F" Series Standard Duty Residential

1

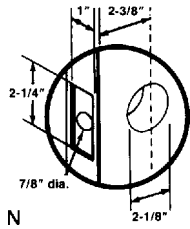

Turn Button provides visible locking status

Inside Knob and Rose Assembly

Demountable Outside Knob for quick rekeying or cylinder replacement

Construction: Engineered with fewer parts for fast and easy installation and durability. Cold rolled steel mechanisms with independent knob and latch springs, all zinc plated and dichromated for corrosion resistance. Wrought brass and bronze knobs and roses.

1/2" throw deadlocking "anti-shim" latchbolt provided positive stop against bolt retraction when door is closed.

Keying: Schlage precision pin tumbler cylinder with five-pin "C" keyway, with nickel silver pins and two keys each.

Installation: For hollow metal or wood doors and frames, 2-3/8" backset completely reversible for RH or LH doors.

5 Pin Tumbler Cylinder

Outside Rose and Chassis

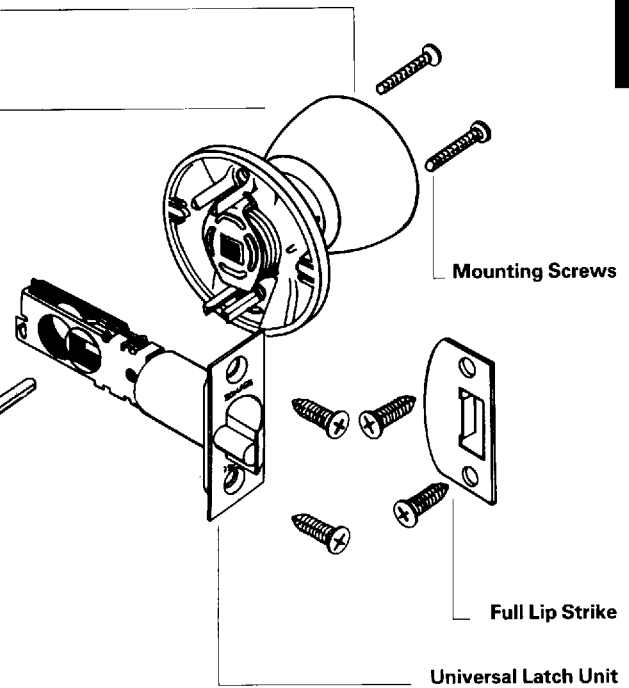

Universal Latch Unit
1/2" Throw
Reversible Latch fits both 2 3/8" and 2 3/4" backset

- Certified ANSI, A156.2 Series Grades 2 and 3, F10S, F40S-Grade 3.
- Door Range: 1-3/8" - 1-3/4"
- Backset: 2-3/8" STD. 2-3/4" allowable.
- Mechanism and internal parts: Cold rolled steel corrosion treated for normal atmospheric conditions.
- Exposed Trim: Knobs and roses are wrought brass and bronze. All roses are 2-9/16" diameter, knobs 1-7/8", 2"

Georgian (GEO)

Plymouth (PLY)

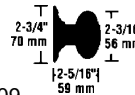
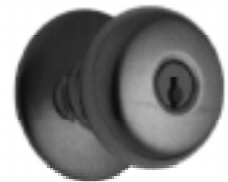
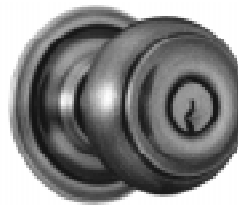

Finishes: 605, 609



Finishes: 605, 626

Orbit (ORB)

Flair (FLA)

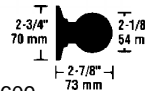

Finishes: 605, 609

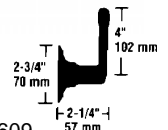

Finishes: 605, 609

Functions



F10 Passage Latch
Both knobs always free, rotating either knob will retract latchbolt.



F40 Privacy Lock
Both knobs locked or unlocked by turning button in inside knob or from outside by screwdriver, nail file or similar tool in emergency keyway.



F51 Entrance Lock
Opens with key from outside. Outer knob is locked by turning button in inside knob. Inner knob is always free for immediate exit.



F170 Single Dummy Trim
Pull only. Mounting plate snap-on rose and knob.

Stock

Georgian All Functions
Orbit All Functions
Plymouth All Functions

Flair All Functions / Specify handing
Exterior of entry available with either Georgian or Orbit knob. Order Entry (S51PD Flair for lever on both sides.

Keyed

Knob: 2-1/8" Dia.
Rose: 2-9/16" Dia.
Proj: 2 5 1/16"

Non-keyed

1-7/8" Dia.
2-9/16" Dia.
2"

1

Schlage "B" Series Standard Duty Deadbolt

This new version of Schlage's 1" throw dead bolt lock will fit a 1-1/2" hole installation; or by using the trim collar, furnished as standard, it will replace locks in a door with a 2-1/8" hole preparation.

Applications: For use as a primary or auxiliary lock for residential or light commercial construction.

Backset: Adjustable: 2-3/8" or 2-3/4".

Cylinders: Precision pin tumbler cylinders with brass cylinder plug and body, high quality pins and springs with two nickel silver keys.

Keying: 5 Pin "C" section standard. Can be incorporated into Schlage Master key and Construction key systems, both residential and commercial.

Certifications: ANSI A 156.5 series grade 3. ASTM F476-76.

Shipping: Individually packed with instructions and template.

All "B100N" Series deadlocks feature a strong 1" throw deadbolt, as recommended by crime prevention experts nationwide.

B160N Deadbolt Lock

Single Cylinder Deadbolt thrown or retracted by key from outside or by inside turn unit. Deadbolt automatically deadlocks when fully thrown.

Stock

B160N	605
B160N	609
B160N	613
B160N	625
B160N	626

B162N Deadbolt Lock

Double Cylinder Deadbolt thrown or retracted by key from either side. Deadbolt automatically deadlocks when fully thrown.

Stock

B162N	605
B162N	609
B162N	613
B162N	625
B162N	626

12-237 Deadbolt

1" Square corner standard. Adjustable 2-3/8" or 2-3/4" backset. Stock Finish 605.

Finishes	605	Bright Brass
	609	Antique Brass
	612	Satin Bronze
	613	Oil Rubbed Bronze
	625	Bright Chromium
	626	Satin Chromium



B160N Dead Lock
Deadbolt thrown or retracted by key from outside or by inside turn unit.

B162N Double Cylinder Dead Lock
Deadbolt thrown or retracted by key from either side.

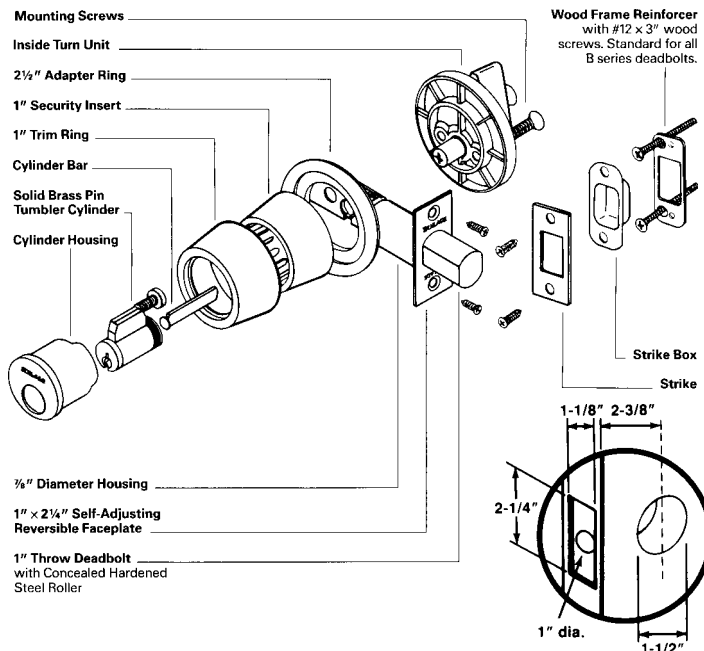

B160N

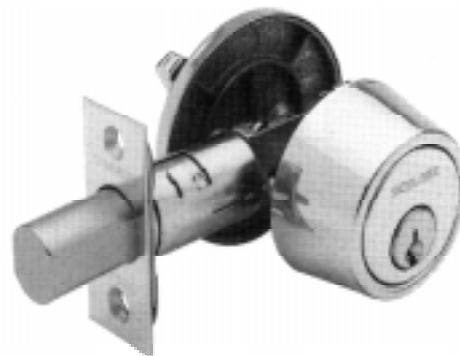

B162N



These new deadbolt locks are constructed with a reinforced tapered cylinder ring that resists wrenching. Their high quality brass pin tumbler cylinders can be keyed to other Schlage locks. Single cylinder functions have large lever action, inside turn unites for easy locking, unlocking and emergency exit.

Schlage "B" Series Heavy Duty Deadbolt Locks

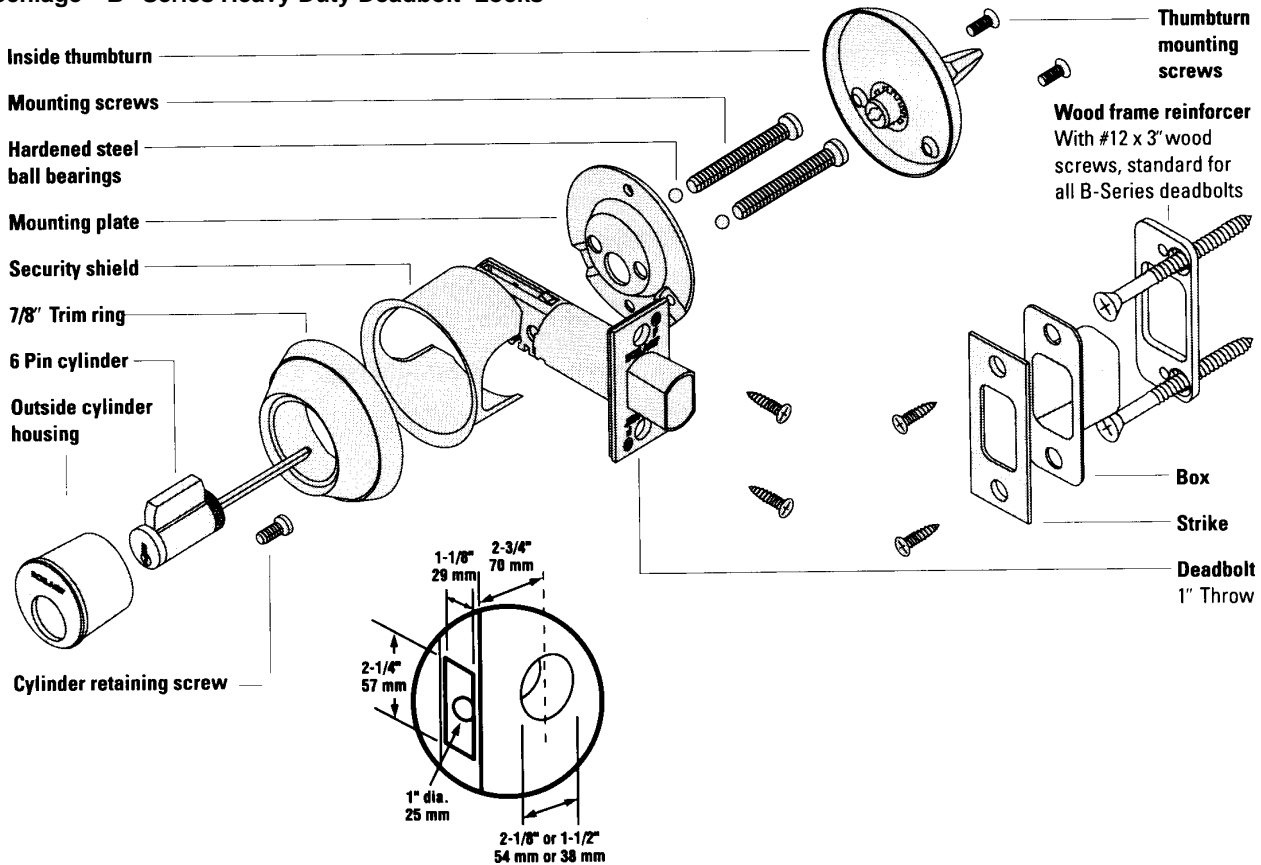

"B" Series Heavy Duty Deadbolt Locks: Auxiliary and primary locking for commercial and residential buildings designed to meet various security, door preparation and functional requirements as determined by local codes and life safety regulations. ANSI A156.5-1992 Grade 1.

Keying: Six-pin tumbler with two nickel silver keys per lock. Stock locks are keyed 5 pin. Other keying options include masterkeying, construction keying and interchangeable core.

Door Preparation: Fits 2-1/8" crossbore with metal shield or a 1-1/2" cross bore without the shield. One-inch bore with a 1-1/8" x 2-1/4" square corner faceplate or 1-1/16" bore for the drive-in bolt.

Backset: 2-3/8" Latch (12-630)

Stock	Finishes
B660P Sgl Cyl. Deadbolt	605 Bright Brass 609 Antique Brass
B662P Dbl Cyl. Deadbolt	613 Oil Rubbed Bronze 625 Bright Chromium 626 Satin Chromium

Commercial Applications

Backset: 2-3/4" Latch (12-631)

B660P Sgl Cyl. Deadbolt	613 Oil Rubbed Bronze 626 Satin Chromium
--------------------------------	---

***B663P Classroom Function** 626 Satin Chromium

***B663 is available with 6-pin "E" Keyway if required.**

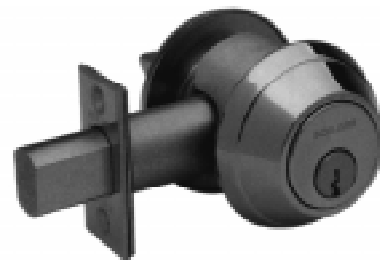

B660 and B662 Heavy Duty Single or Double Cylinder

A commercial quality deadbolt that provides an extra measure of security to the residential or commercial application. The deadbolt features a 1/4" hardened steel roller to add resistance to sawing or cutting through the bolt.

Functions

B660 Deadbolt Lock
Deadbolt thrown or retracted by key from outside or by inside turn unit.

B662 Double Cylinder Deadbolt Lock
Deadbolt thrown or retracted by key from either side.

B663 Classroom Deadbolt Lock
Deadbolt thrown or retracted by key outside. Inside turn until will retract bolt only. Bolt automatically deadlocks when fully thrown.

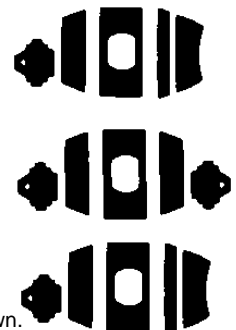

Schlage A Latch and Backset Variations

1

"A" locks can be furnished with latch and backset to meet most installation requirements. "A" locks are available with 2-3/8", 2-3/4" and 3-3/4" backset latches. By joining an extension link to a 2-3/8" backset latch locks can be placed 5" or more back from the door edge.

Extension Links

41-005 5" Backset
Extension Link

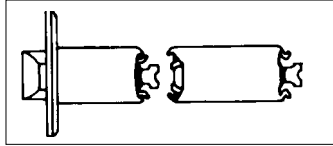

10-001 Strike

Size: 2-3/4" x 1-1/8" x 3/32"
Lip: 1-1/8"
Finishes: 605, 613, 626

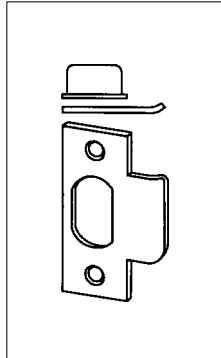

10-025 ASA Strike ANSI

Size: 4-7/8" x 1-1/4" x 3/32"
Lip: 1-3/16" Standard
Finish: 605, 613, 626

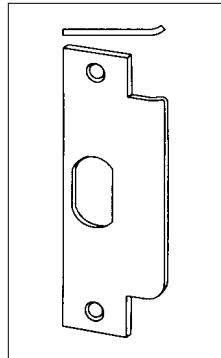

Deadlatch

11-085 Backset: 2-3/8"
Finishes: 605, 626

11-096 Backset: 2-3/4"
Finishes: 613, 626

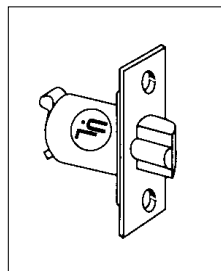

Pin Kit - Snap-tight Plastic Box

40-134 - Keying Kit

Kit contains: Bottom Pins, Top Pins, and Pin Springs; Retainer cap pins, Key Gage and Follower.

